



YUC. | MEX.

# COSTA SISAL

Residential Apartments

[COSTASISAL.COM](http://COSTASISAL.COM)



*Exclusivity has a new name*  
*Costa Sisal*



**TERRALAND**  
SOLUCIONES INMOBILIARIAS  
TERRALAND.MX.COM

*All images shown are for illustrative purposes only and are merely representative. The furniture displayed is for reference only to help visualize the spaces and is not part of the final product. Elements, finishes, and dimensions may vary from the final delivery and do not constitute a commitment or guarantee by the developer.*



*Welcome to:*

# COSTA SISAL



Costa Sisal is an exclusive beachfront residential development located on one of the most beautiful beaches in Yucatán, in the charming town of Sisal. Designed for those dreaming of a home by the sea or seeking a secure investment with strong capital appreciation, this project offers the perfect balance of comfort and profitability.

Live in paradise and watch your investment grow in one of the most promising areas along the Yucatán coast.

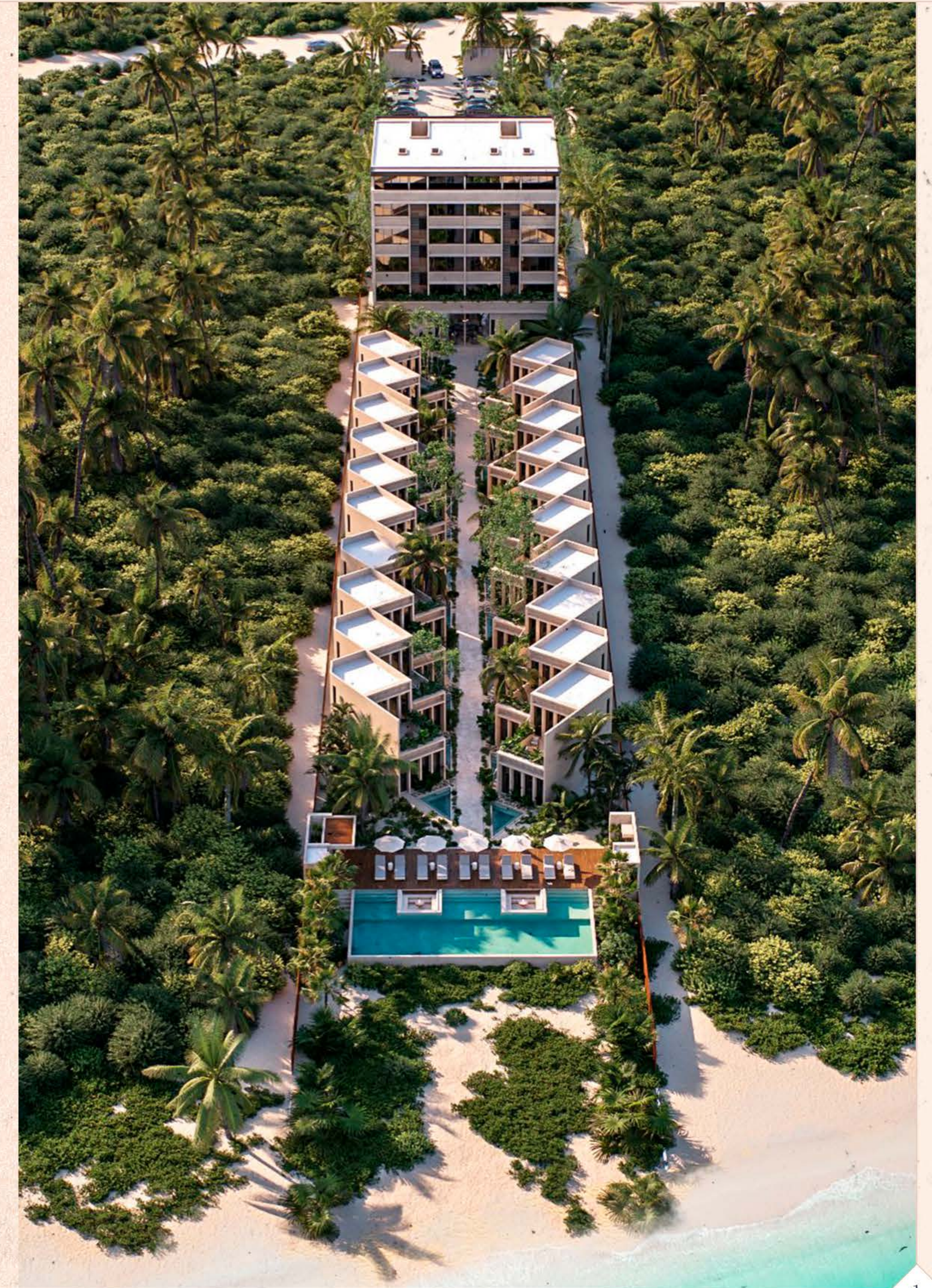



*¿Where are we?*

# LOCATION



Located in the magical town of Sisal, just 8 km from the pier, on one of the most exclusive beaches in Yucatán.

With a privileged connection to Mérida, our complex offers an exclusive retreat where the serenity of the sea is just moments away from the city.

We are the perfect opportunity to live or invest by the sea, with all the comforts to enjoy life to the fullest.

*Find us instantly! Just scan this code with Google Maps.*

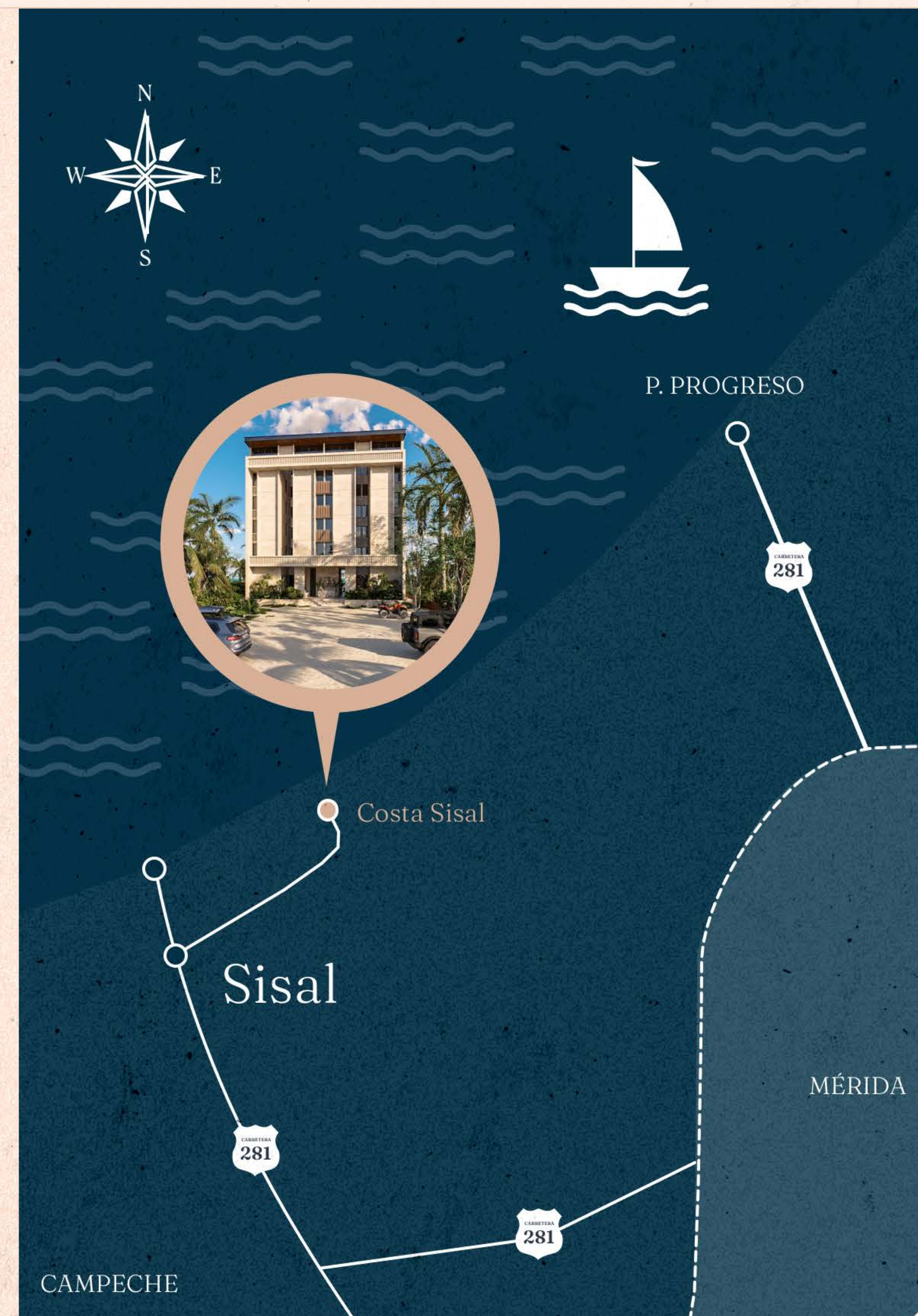





Luxury living

# AMENITIES

At Costa Sisal, every day is a paradise escape



Bar



Kids Club



Pool

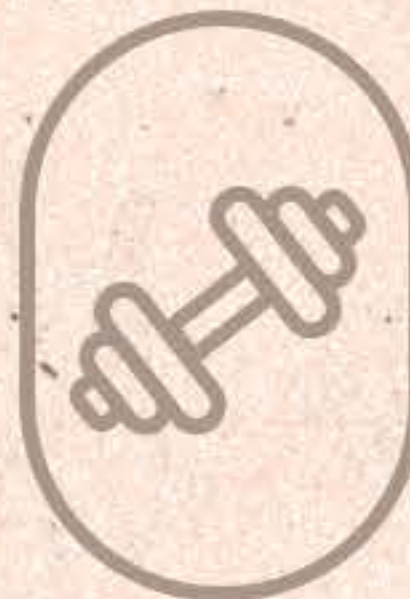

Gym



Co-Working  
space



Perimeter fence  
(Concreto - Bajareque)



Playground



Lounge chair  
zones



Convenience  
store



Parking spaces

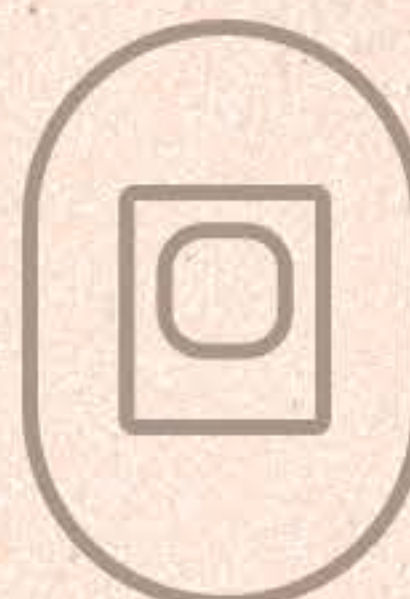

laundry area



24/7 surveillance



INTERNET-READY FOR INSTALLATION



# MASTER PLAN



*All images shown are for illustrative purposes only and are merely representative. The furniture displayed is for reference only to help visualize the spaces and is not part of the final product. Elements, finishes, and dimensions may vary from the final delivery and do not constitute a commitment or guarantee by the developer.*



*Designed  
for you*



# DEPARTMENT | A-Studio

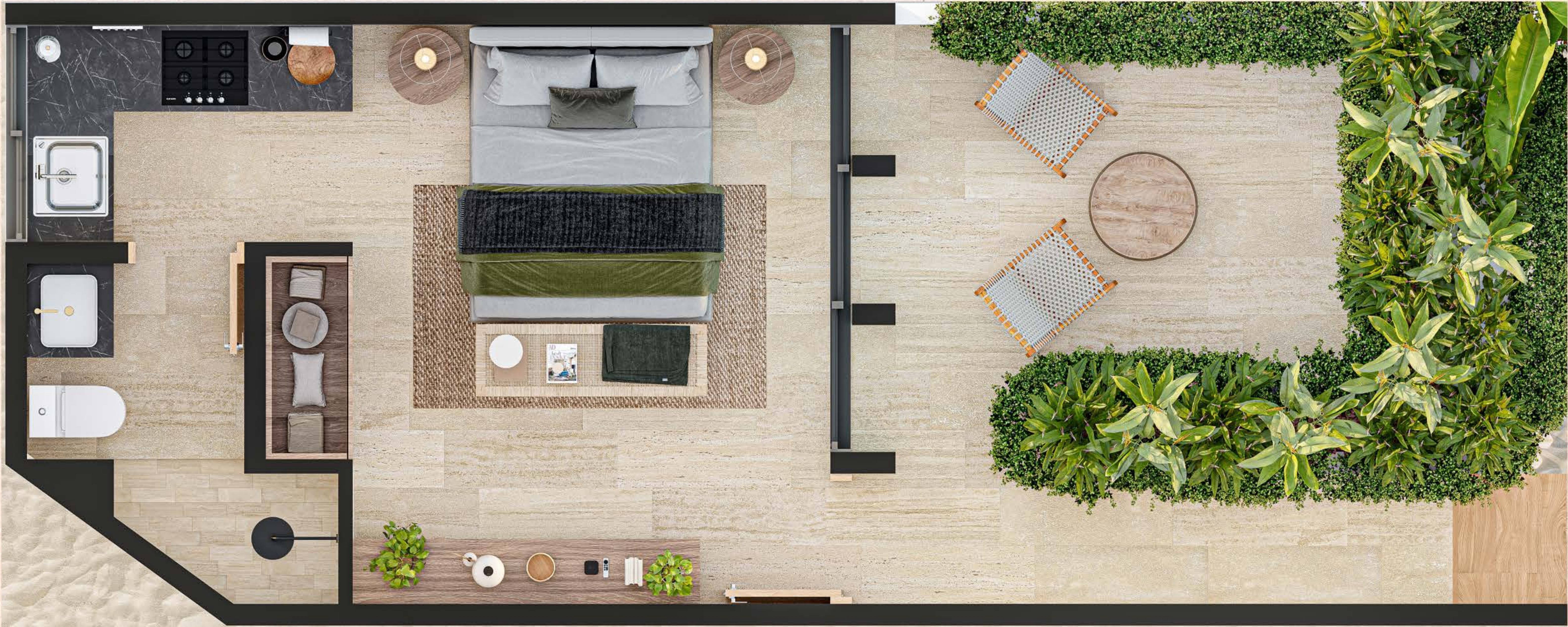

## TECHNICAL SHEET

- Property type: Studio
- Location: Second level
- Covered area: 24.28 m<sup>2</sup>
- Terrace: 12.71 m<sup>2</sup>
- Total area: 36.99 m<sup>2</sup>

## LAYOUT

- 1 Bedroom
- 1 Full bathroom
- Full Kitchen
- Balcony
- Parking for 1 vehicle

All images shown are for illustrative purposes only and are merely representative. The furniture displayed is for reference only to help visualize the spaces and is not part of the final product. Elements, finishes, and dimensions may vary from the final delivery and do not constitute a commitment or guarantee by the developer.



# DEPARTAMENT | B- 1 Bedroom



## TECHNICAL SHEET

- Property type: 1 Bedroom
- Location: Firts floor
- Covered area: 43.72 m²
- Terrace with pool: 7.15 m²
- Total area: 50.87 m²

## LAYOUT

- 1 Bedroom
- 1 Full bathroom
- Full Kitchen
- Terrace, Pool
- Living-dining area
- Parking for 1 vehicle

All images shown are for illustrative purposes only and are merely representative. The furniture displayed is for reference only to help visualize the spaces and is not part of the final product. Elements, finishes, and dimensions may vary from the final delivery and do not constitute a commitment or guarantee by the developer.



C

# DEPARTAMENT | C- 2 Bedroom

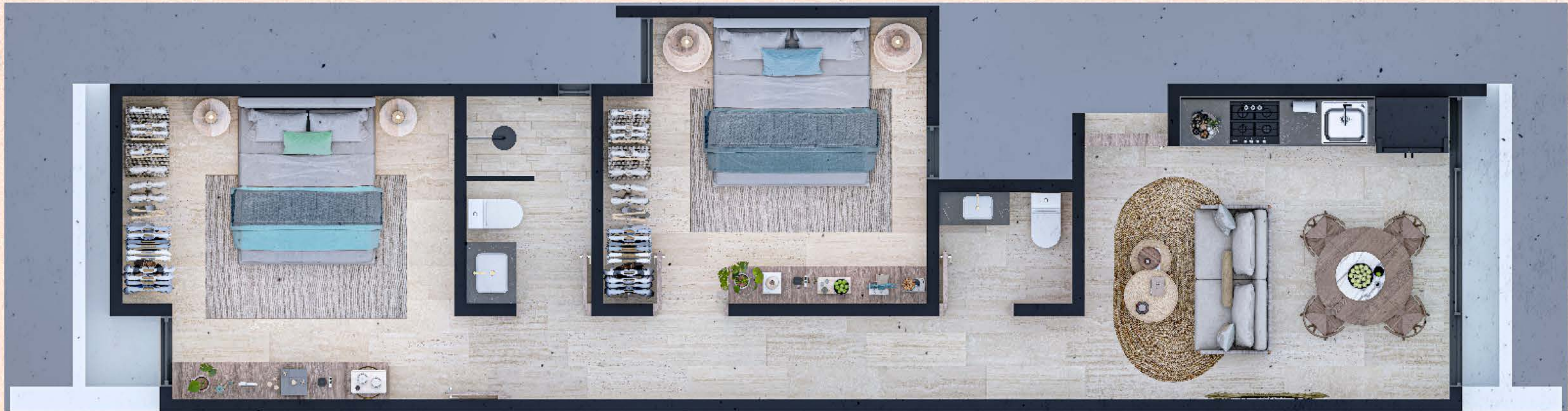

## TECHNICAL SHEET

- Property type: 2 Bedroom
- Location: Main tower
- Covered area: 64.66 m²
- Total area: 64.66 m²

## LAYOUT

- 2 Bedroom
- 1 Full bathroom
- 1 Powder room
- Full Kitchen
- Balcony
- Living-dining area
- Parking for 1 vehicle

All images shown are for illustrative purposes only and are merely representative. The furniture displayed is for reference only to help visualize the spaces and is not part of the final product. Elements, finishes, and dimensions may vary from the final delivery and do not constitute a commitment or guarantee by the developer.



# DEPARTAMENT | D- 2 Bedroom, Balcony



## TECHNICAL SHEET

- Property type: 2 Bedroom
- Location: Main tower
- Covered area, Balcony: 74.7m<sup>2</sup>
- Total area: 74.7 m<sup>2</sup>

## LAYOUT

- 2 Bedroom
- 1 Full bathroom
- 1 Powder room
- Full Kitchen
- Terrace and Balcony
- Living-dining area
- Parking for 1 vehicle

All images shown are for illustrative purposes only and are merely representative. The furniture displayed is for reference only to help visualize the spaces and is not part of the final product. Elements, finishes, and dimensions may vary from the final delivery and do not constitute a commitment or guarantee by the developer.



C



*Your  
perfect  
opportunity*

## DEPARTMENTS

FROM  
**\$1,500,000** MXN

RESERVE WITH ONLY **\$20,000** MXN

Flexible payment plans available:

**6, 12, 24**  
Installments

**\*BANK FINANCING AVAILABLE\***



*Your beachfront apartment is waiting. **Make it yours today!***

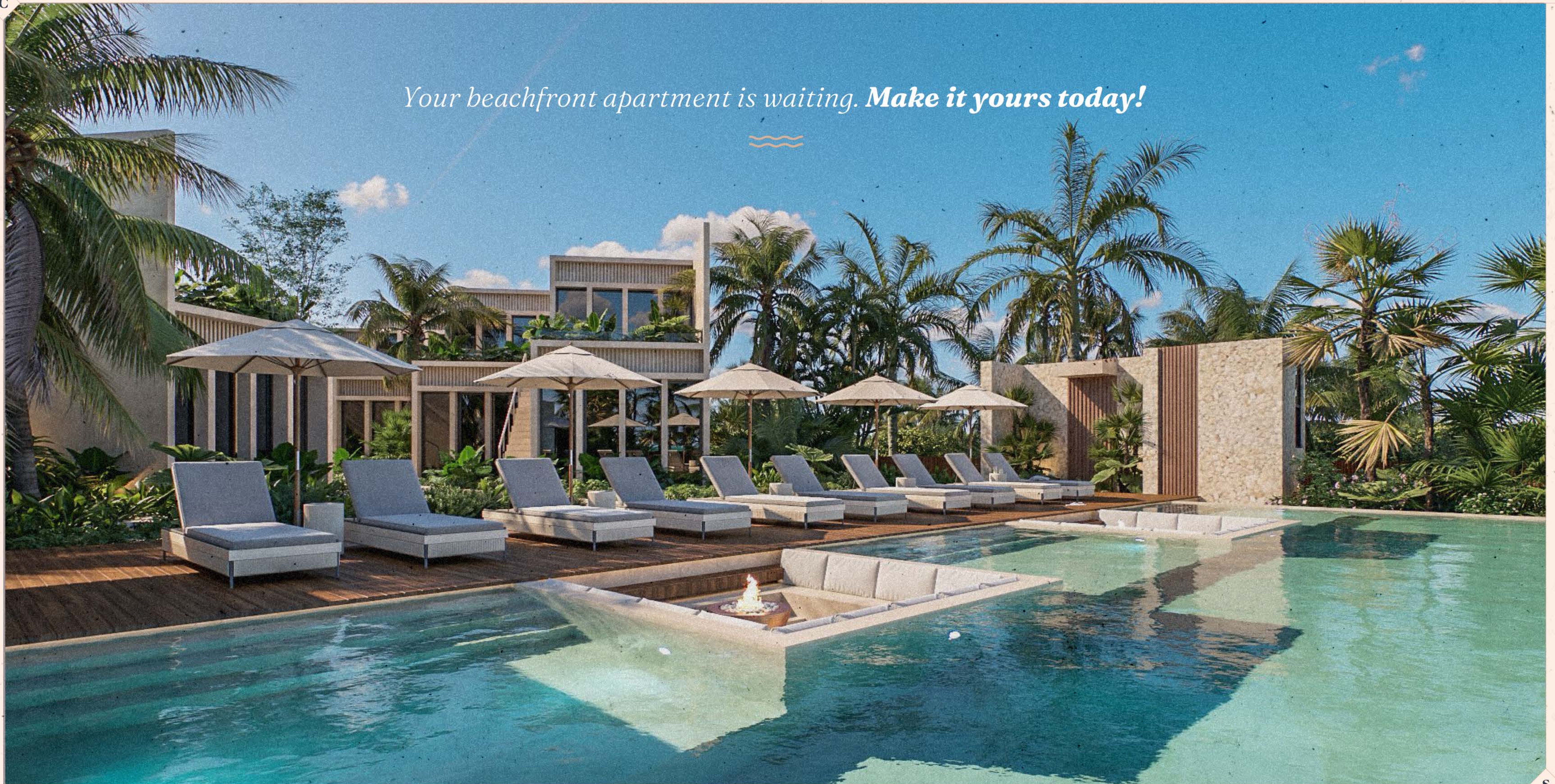





YUC. | MEX.

**COSTA SISAL**

DEPARTAMENTOS RESIDENCIALES

COSTASISAL.COM



**TERRALAND**  
SOLUCIONES INMOBILIARIAS

TERRALAND.COM.MX

C.3 #48 esquina 26 depto. 2, Col. San Antonio Cinta. C.P. 97139. 97125 Mérida,